

IC RNS 165

Technical Sheet

Woofer



SPECIFICATIONS

Nominal power	60W	
Maximum power	120W	
Sensitivity (2,83V/1m)	92 dB	
Cone	Braided glass fiber*	
Surround	Butyl	
Nom. impedance	4Ω	
DC resistance	3.5Ω	
VC diameter	25mm	1"
VC height	11mm	0 ⁵ / ₁₆ "
Former	Kapton	
Layers	2	
Wire	Copper	
Inductance		
Xmax	2.5mm	0 ¹ / ₁₆ "
Magnet d x h	85mm x 15mm	3 ¹ / ₃ x 0 ⁹ / ₁₆ "
Magnet weight	0.35kg	0.66lb
Flux density	1.3T	
Gap height	5.5mm	0 ³ / ₁₆ "
Net weight	850g	1.87lb

FREQUENCY RESPONSE/IMPEDANCE

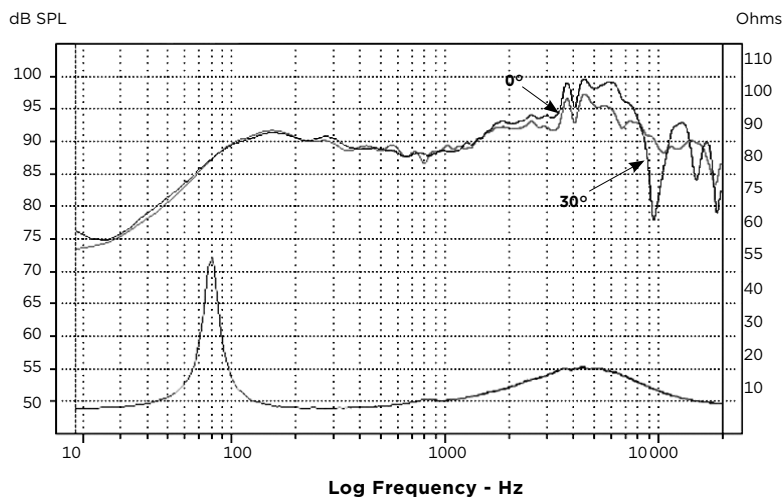

PARAMETERS

Fs	79.28Hz
Vas	7.44l
Qts	0.92
Qes	1.04
Qms	7.94
Re	3.54 Ohms
Sd	1373cm ²
Cas	6.04 E-08m ⁵ /N
Mas	66.75kg/m ⁴
Ras	4187.53 Ohms.ac
Cms	3.22E-04 m/N
Mms	12.5g
Rms	0.784kg/s
Ces	596.52mF
Les	6.76mH
Res	26.72 Ohms
BI	4.58N/A
SPL	87.93dB/W/m

MECHANICAL DRAWING

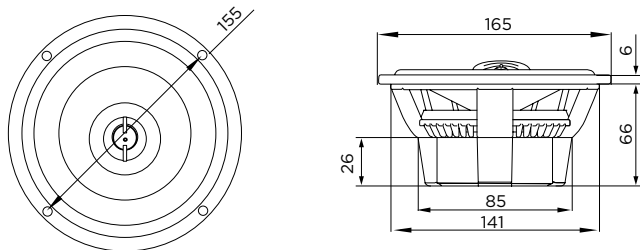

FOCAL[®] INSIDE

Focal[®] is a trademark of Focal-JMLab[®] - www.focal.com - SCAA190319/1

 **FOCAL**[®]
LISTEN BEYOND