

K2 POWER ES 130 K

Woofer 5"



- K2 Power sandwich cone
- "TMD" surround (patented technology)
- Aluminum compact basket

SPECIFICATIONS

Nominal power	80W	
Maximum power	160W	
Sensitivity (2,83V/1m)	90dB	
Cone	Kevlar sandwich	
Nom. impedance	4Ω	
Surround	Butyl	
DC resistance	3Ω	
VC diameter	25mm	0.6364"
Former	Kapton	
Layers	2	
Wire	CCA W	
Magnet (dxh)	80x17mm	0.3152x0.4364"
Net weight	800g	1.76lbs

FREQUENCY RESPONSE/IMPEDANCE

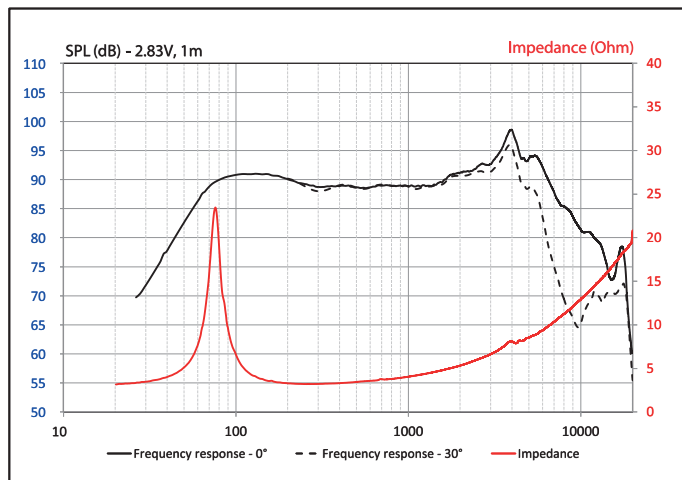

PARAMETERS

Rdc	3 Ω
Fs	78Hz
Mms	9.4g
Cms	0.4mm/N
Vas	4.3l
Qts	0.82
Qes	0.949
Qms	6.7
Bxl	3.9 N/A
Sd	83.3cm ²
SPL	87.2dB
Xmax	4.5mm

MECHANICAL DRAWING

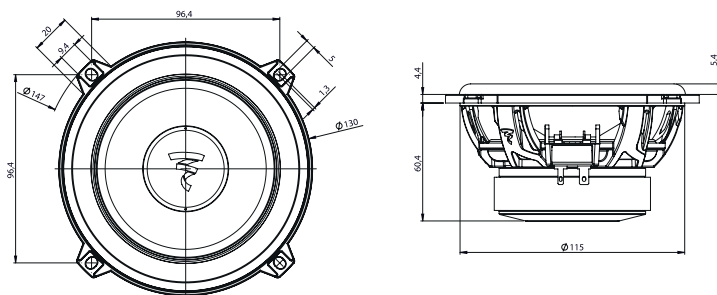

 **Elite**
"HAUTE COUTURE" SOUND

 **FOCAL**[®]
THE SPIRIT OF SOUND