

AUDITOR RSB-300

Subwoofer (12")



- Polypropylene cone
- Steel basket
- 4 Ω dual voice coil

SPECIFICATIONS

Nominal power	300W RMS	
Maximum power	600W	
Sensitivity (2,83V/1m)	90dB	
Cone type	Polypropylene	
Surround type	Butyl	
Nom. impedance	4Ω + 4Ω	
DC resistance	3.2Ω + 3.2Ω	
VC diameter	50mm	2"
Net weight	4300g	9.48lbs

FREQUENCY RESPONSE/IMPEDANCE

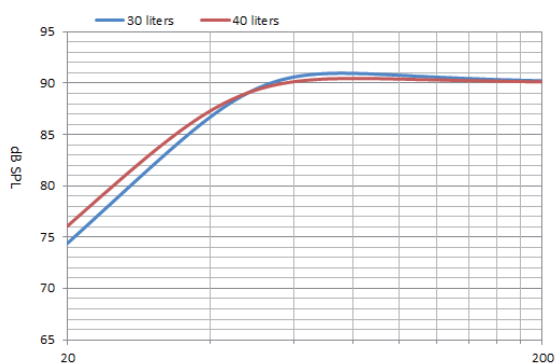

— Frequency response 0° - - - Frequency response 30° — Impedance Z

PARAMETERS

Fs	25Hz
Vas	93l
Qts	0.47
Qes	0.52
Qms	4.5
Re	3.2Ω + 3.2Ω
Sd	471cm ²
Cms	0.3mm/N
Mms	130g
Bl	8.3 N/A

MECHANICAL DRAWING

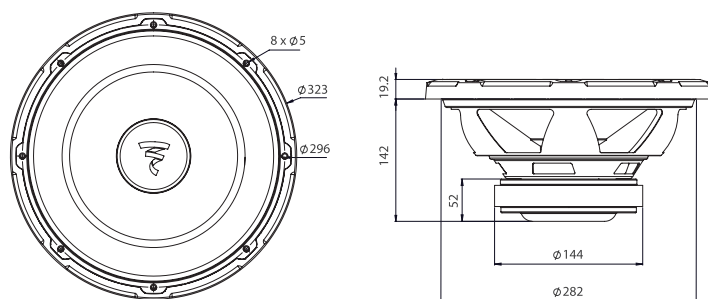

Performance
CREATE YOUR SOUND

FOCAL